



OPERATION MANUAL

MANUAL NUMBER X039680 | REVISION B | ENGLISH (US)

EVO™ HVLP Sprayer

For portable spray applications of water-based and oil-based non-flammable architectural paints and coatings only.

Not approved for use in explosive atmospheres or hazardous locations. For household use only.



Important Safety Instructions

Read all warnings and instructions in this manual before using the equipment. Be familiar with the proper control and usage of the equipment. Save these instructions.



graco.com/contact

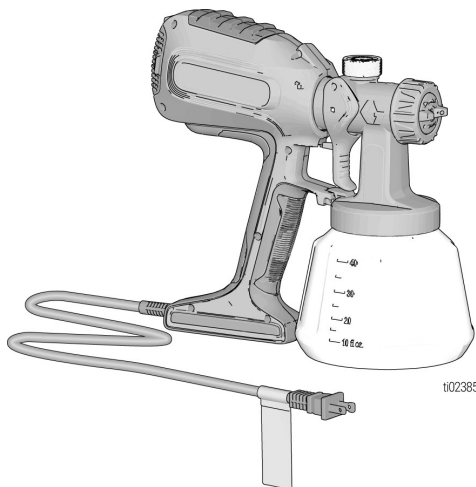



CONTENTS

Models	3
Important User Information	4
Translated Manuals	5
Safety Symbols	6
General Warnings	7
Technical Specifications	9
Component Identification	10
Know Your Controls	12
Setup	13
EVO and EVO Plus	13
Startup	14
Operation	15
Spray Material	15
Air Cap Orientation	15
Spray Nozzle	15
Change the Nozzle	16
Spray Pattern Quality	16
Spray Angle	17
Aim the Sprayer	17
Trigger Timing	17
Clear the Nozzle	17
Cup Refills	18
Pause in Spraying	18
Cleanup	19
Fluid Compatibility	19
Clean the Sprayer	19
Clean the Spray Head	20
Clean Nozzle and Air Cap	21
Repair	22
Gasket Replacement	22
Replace the Outer Gasket	22
Replace the Inner Gasket	23
Parts Repair and Replacement	23
Storage	24
Long Term Storage	24
Recycling and Disposal	25
End of Product Life	25
Troubleshooting	26
California Proposition 65	29

MODELS

Part numbers reflect distinct features and characteristics of the EVO HVLP Sprayer.

EVO HVLP SPRAYER MODELS AND APPROVALS

MODEL	PART NUMBER	VOLTAGE	APPROVALS
EVO	27F400	120 V	
EVO Plus	27F401		
EVO	27F403	230 V	
EVO Plus	27F404		

REPLACEMENT KITS

PART ORDER NO.	DESCRIPTION	COMPATIBLE MODELS
2008040	KIT, EVO and EVO Plus spray head, 40 oz cup	27F400, 27F401, 27F403. 27F404
2008041	NOZZLES: 1.0 mm, 1.5 mm, 2.0 mm, 3.0 mm	
	AIR CAP: wide, narrow	
2008042	GASKETS, cup (inner and outer), 3 pack	
	AIR FILTER, EVO and EVO Plus, 3 pack (discard filters that do not fit your unit)	
2008043	KIT, 40 oz cup, strainer, storage lid	

ONLINE RESOURCES

Visit our Website:	graco.com/homeowner
Operational Videos:	graco.com/homeeducationcenter
Manuals:	graco.com/homeownersupport
Parts Online:	graco.com/homeownerparts

IMPORTANT USER INFORMATION

Thank You for Your Purchase!

This sprayer is designed to provide superior spray performance with water-based and oil-based (mineral spirit-type) architectural paints and coatings. This user information is intended to help you understand the types of materials that can be used with your sprayer.

Please read the information on the material container label to determine if it can be used with your sprayer. Ask for a Safety Data Sheet (SDS) from your supplier. The container label and SDS will explain the contents of the material and the specific precautions related to it.

Paints, coatings and clean-up materials generally fit into one of the following **3 basic categories**:



WATER-BASED: The container label should indicate that the material can be cleaned up with soap and water. Your sprayer is compatible with this type of material. Your sprayer is **NOT** compatible with harsh cleaners such as chlorine bleach.



OIL-BASED: The container label should indicate that the material is COMBUSTIBLE and can be cleaned up with mineral spirits or paint thinner. The SDS must indicate that the flash point of the material is above 100° F. Your sprayer is compatible with this type of material. Use oil-based material outdoors or in a well-ventilated indoor area with a flow of fresh air. See the safety warnings in this manual.



FLAMMABLE: This type of material contains flammable solvents such as xylene, toluene, naphtha, MEK, lacquer thinner, acetone, denatured alcohol, and turpentine. The container label should indicate that this material is FLAMMABLE. This type of material is **NOT** compatible with your sprayer and **CANNOT** be used.

NOTICE

Your sprayer is **NOT** compatible with harsh cleaners such as chlorine bleach. Using these cleaners will cause damage to the sprayer.

TRANSLATED MANUALS

Additional language documents are available to support all regions where the EVO HVLP Sprayer is sold. Find any available translations at www.graco.com.





Table 3-1: Translations for EVO HVLP Sprayer Manual

LANGUAGE	MANUAL NUMBER
English	X039680EN
French	X039680FR
Spanish	X039680ES

SAFETY SYMBOLS

The following safety symbols appear throughout this manual and on warning labels. Read the table below to understand what each symbol means.

SYMBOL	MEANING
	Electric Shock Hazard
	Equipment Misuse Hazard
	Fire and Explosion Hazard
	Toxic Fluid or Fumes Hazard
	Do Not Use Flammable Materials
	Eliminate Ignition Sources

SYMBOL	MEANING
	Ground Equipment
	Read Manual
	Ventilate Work Area
	Wear Personal Protective Equipment



Safety Alert Symbol

This symbol indicates: Attention! Become Alert! Look for this symbol throughout the manual to indicate important safety messages.

GENERAL WARNINGS

The following warnings apply throughout this manual. Read, understand, and follow the warnings before using this equipment. Failure to follow these warnings can result in serious injury.

WARNING



FIRE AND EXPLOSION HAZARD

Flammable fumes, such as solvent and paint fumes, **in work area** can ignite or explode. To help prevent fire and explosion:



- Do not spray or clean with materials having flash points lower than 100° F (38° C). Use only non-flammable or water-based materials, or non-flammable paint thinners. For complete information about your material, request Safety Data Sheets (SDSs) from the material distributor or retailer.



- Do not spray combustible materials near an open flame or sources of ignition such as cigarettes, motors, and electrical equipment.



- Verify that all containers and collection systems are grounded to prevent static discharge. Do not use pail liners unless they are anti-static or conductive.



- **Stop operation immediately** if static sparking occurs or you feel a shock. Do not use equipment until you identify and correct the problem.

- Do not use a paint or solvent containing halogenated hydrocarbons.

- Keep spray area well-ventilated. Keep a good supply of fresh air moving through the area.

- Sprayer generates sparks. Keep pump assembly in a well-ventilated area when spraying, flushing, cleaning or servicing.

- Do not smoke in the spray area or spray where sparks or flame is present.

- Do not operate light switches, engines, or similar spark producing products in the spray area.

- Keep area clean and free of paint or solvent containers, rags, and other flammable materials.

- Know the contents of the paints and solvents being sprayed. Read all Safety Data Sheets (SDSs) and container labels provided with the paints and solvents. Follow the paint and solvent manufacturer's safety instructions.

- Keep a working fire extinguisher in the work area.



ELECTRIC SHOCK HAZARD

Improper setup, or usage of the system can cause electric shock.

- Turn off and disconnect power cord before servicing equipment.

- Do not expose to rain. Store indoors.



WARNING



EQUIPMENT MISUSE HAZARD

Misuse can cause death or serious injury.

- Always wear appropriate gloves, eye protection, and a respirator or mask when painting.
- Do not operate or spray near children. Keep children away from equipment at all times.
- Do not overreach or stand on an unstable support. Keep effective footing and balance at all times.
- Stay alert and watch what you are doing.
- Do not operate the unit when fatigued or under the influence of drugs or alcohol.
- Do not use the hose as a strength member to pull or lift the equipment.
- Do not alter or modify equipment. Alterations or modifications may void agency approvals and create safety hazards.
- Make sure all equipment is rated and approved for the environment in which you are using it.



TOXIC FLUID OR FUMES HAZARD

Toxic fluids or fumes can cause serious injury or death if splashed in the eyes or on skin, inhaled, or swallowed.

- Read Safety Data Sheets (SDSs) to know the specific hazards of the fluids you are using.
- Store hazardous fluid in approved containers, and dispose of it according to applicable guidelines.



PERSONAL PROTECTIVE EQUIPMENT

Wear appropriate protective equipment when in the work area to help prevent serious injury, including eye injury, hearing loss, inhalation of toxic fumes, and burns. Protective equipment includes but is not limited to:

- Protective eyewear and hearing protection.
- Respirators, protective clothing, and gloves as recommended by the fluid and solvent manufacturer.

TECHNICAL SPECIFICATIONS

The table provides important information related to the EVO HVLP Sprayer, including product attributes, measurements, and performance characteristics that support the use of the equipment.

Table 6-1: Technical Specifications for EVO HVLP Sprayer

	US	METRIC
Weight		
EVO	2.7 lb (18 in. cord)	1.2 kg (45 cm cord)
EVO Plus	3.2 lb (18 in. cord)	1.4 kg (45 cm cord)
Dimensions		
Length EVO	11.8 in.	30 cm
Length EVO Plus	12.0 in.	30.4 cm
Width EVO/EVO Plus	6.1 in.	15.5 cm
Height EVO/EVO Plus	11 in.	27.9 cm
Maximum Temperatures		
Storage temperature range ♦	32°F to 113°F	0°C to 45°C
Operating temperature range ✓	40°F to 90°F	4°C to 32°C
Storage humidity range	0% to 95% relative humidity, non-condensing	
Inlet/Outlet Sizes		
Maximum nozzle size	0.039 in.	3.0 mm
Materials of Construction		
Wetted materials on all models	Brass, polypropylene, nylon, acetal, foamed rubber	
Notes		
♦ <i>Damage to plastic parts may result if impact occurs in low temperature conditions.</i>		
✓ <i>Changes in paint viscosity at very low or very high temperatures can affect sprayer performance.</i>		
All trademarks or registered trademarks are the property of their respective owners.		

COMPONENT IDENTIFICATION

The diagram highlights the controls and features on the EVO HVLP Sprayer that are used during typical operation.
EVO AND EVO PLUS

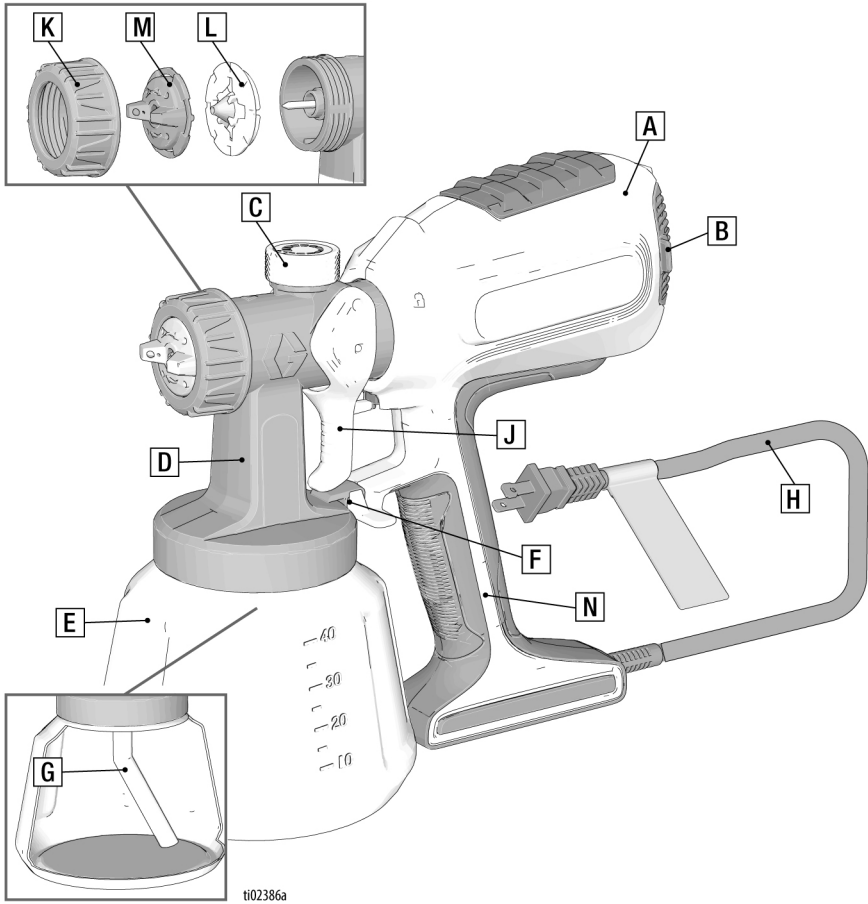
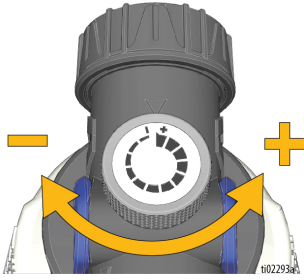

Figure 7-1: Components for EVO HVLP Sprayer (model 27F400 shown)

COMPONENT IDENTIFICATION

KEY

- A Turbine
- B Vent Cover
- C Flow Control Knob
- D Spray Head
- E Cup
- F Lock
- G Suction Tube
- H Power Cord
- J Trigger
- K Union Nut
- L Nozzle
- M Air Cap



Flow Control

The Flow Control Knob adjusts the amount of fluid that is coming from the sprayer.

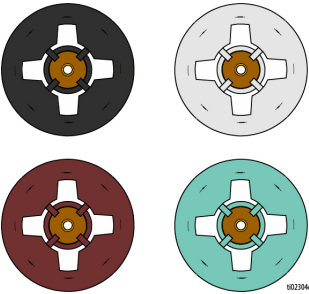

Nozzles

Different size Nozzles are key to spraying different materials effectively. Changing to the smaller Nozzles when using thinner materials means that you can achieve a good spray pattern without heavily restricting the flow.

See **Spray Nozzle**.

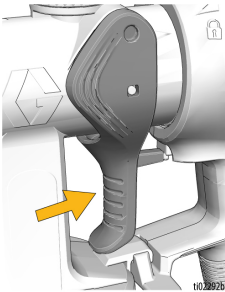

Trigger

The EVO and EVO Plus have a two-stage trigger. The first stage engages the turbine and the second stage allows for the transportation of the material. When spraying, make sure to fully squeeze the trigger.

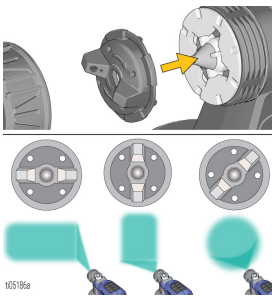

Air Cap

The Air Cap is installed over the Nozzle and is the key to creating the spray pattern.

The Air Cap produces three fan patterns: vertical, horizontal, and round.

SETUP

When using the equipment for the first time or after long term storage, follow the steps to prepare the EVO HVLP Sprayer for operation.

EVO AND EVO PLUS

1. Unscrew Cup from the Spray Head. Make sure the Suction Tube is installed.

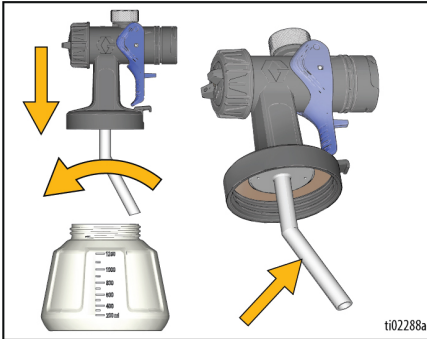

NOTE:

For spraying upwards, place the end of the Suction Tube pointing backward. For spraying downwards, place the end of the Suction Tube pointing forward.

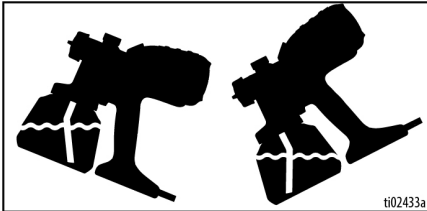

2. Place the included strainer on the Cup. Pour paint through the strainer until paint is level with the top hash mark.

NOTE:

If the paint stops draining, but the Cup is not full, use a stir stick to scrape the captured paint at the bottom of the strainer until the paint resumes draining.

3. Firmly tighten the Cup to the Spray Head.

NOTE:

For easy install, place the Cup on a level surface, then screw the Spray Head onto the Cup.

4. Attach the Spray Head to the Turbine. Place the Turbine at a 90 degree angle to the Spray Head. Connect the Spray Head and Turbine, then turn clockwise until it clicks into place. The Turbine should be in line with the Spray Head.

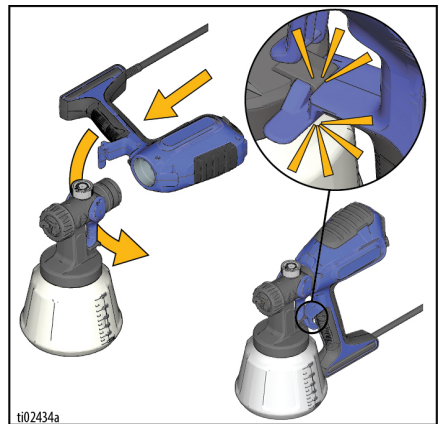

STARTUP

Follow these steps to power the EVO HVLP Sprayer and prepare it for operation.

1. Plug the Power Cord into a power source.

NOTE:

The sprayer has a polarized power cord plug (one blade is wider than the other). This plug will fit in a polarized outlet only one way. If the plug does not fully fit in the outlet, reverse the plug. If it still does not fit, contact a qualified electrician to install the proper outlet. Do not alter the plug in any way.

2. Point the sprayer into a waste pail and squeeze the trigger for five to ten seconds. Material will begin to spray. If the sprayer does not spray after five to ten seconds, stop and check that the Cup is tightly secured to the Spray Head. If the sprayer still does not spray, repeat **Setup**.

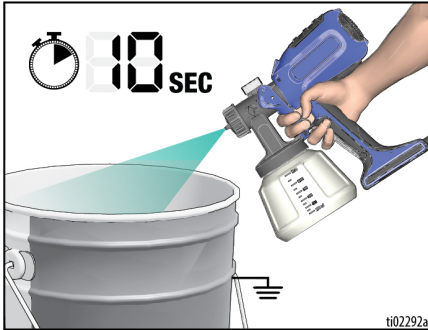

You are now ready to spray!

OPERATION

The instructions provide guidance on how to use the EVO HVLP Sprayer.

SPRAY MATERIAL

⚠️ WARNING			
			
<p>Use only water-based or oil-based (mineral spirit-type) materials with a flash point greater than 100° F (38° C).</p> <p>Do not use materials which state "FLAMMABLE" on the packaging. For more information about your materials, request a Safety Data Sheet (SDS) from the distributor or retailer.</p> <p>When spraying oil-based material, use outdoors or in a well-ventilated indoor area with a flow of fresh air.</p> <p>Keep spray area well-ventilated. Keep a good supply of fresh air moving through the area.</p>			

1. Point the sprayer at a piece of scrap material and squeeze the trigger to test the spray pattern. Adjust the following to achieve the desired spray pattern:
 - a. Flow: Turn Flow Control Knob to reduce the amount of material coming out of the sprayer.
 - b. Distance from surface.
 - c. Hand speed.
 - d. Air Cap orientation. See **Air Cap Orientation**.

NOTE:

If spraying is difficult, material may need to be thinned. If material needs to be thinned, thin per manufacturer's specifications with a compatible material.

AIR CAP ORIENTATION

Orientate the Air Cap to the Horizontal, Vertical, or Round position for the desired output.

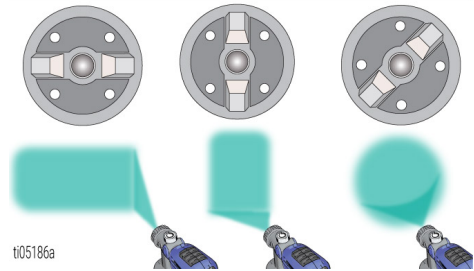
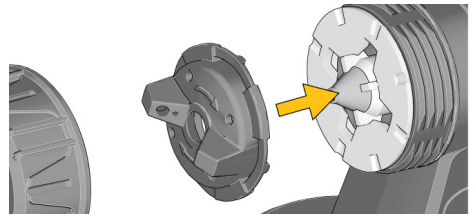

SPRAY NOZZLE

Recommended Nozzle size for Material:

- **Paint:** 2 mm (black) or 3 mm (white)
- **Stain:** 1 mm (red) or 1.5 mm (teal)

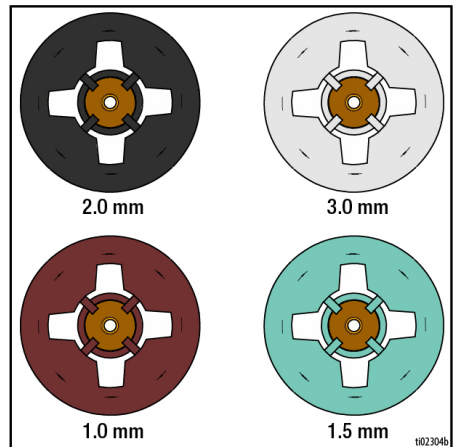

CHANGE THE NOZZLE

The sprayer is shipped with the 3 mm Nozzle installed. To change to a smaller Nozzle, follow the steps below:

1. Unplug the sprayer to prevent accidental triggering.
2. Unscrew the Union Nut and remove the Air Cap.

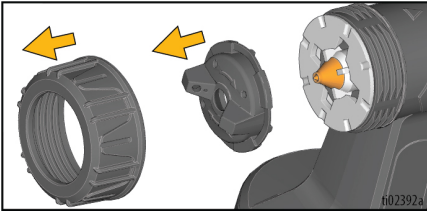

3. Remove the Nozzle by pulling on the outside edge of the Nozzle face.

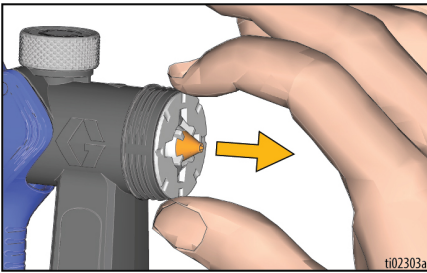

4. Install replacement Nozzle by aligning the notch in the Nozzle with the ridge on the Spray Head.

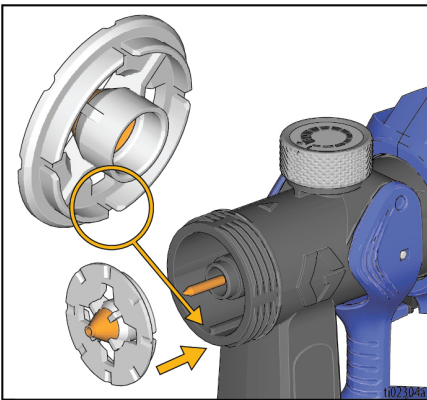

5. Place Air Cap on top of the Nozzle and reinstall the Union Nut. Hand tighten the Union Nut.

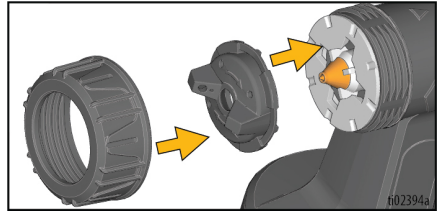

6. Before resuming spraying, spray a test sample onto a piece of scrap material in order to ensure the desired pattern is achieved.

SPRAY PATTERN QUALITY

A good spray pattern is evenly distributed without voids or runs. Adjust sprayer Flow Control, hand speed, and distance from the wall to get a good spray pattern.

If difficulty spraying persists, material may need to be thinned. If material needs to be thinned, thin based on manufacturing specifications with compatible material.

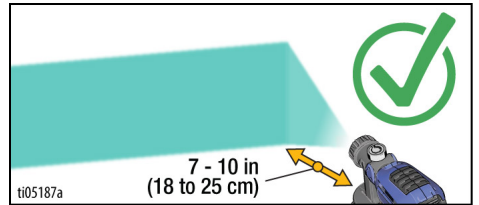

SPRAY ANGLE

Use a piece of scrap material to practice these basic spraying techniques before you begin sprayint the surface.

- Hold sprayer 7-10 in. (18-25 cm) from surface and aim straight at surface. Tilting the sprayer to direct the spray angle causes an uneven finish.

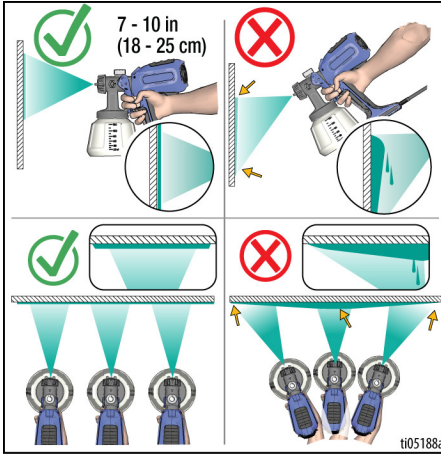

- Flex wrist to keep sprayer pointed straight. Fanning sprayer to direct spray at angle causes an uneven finish.

NOTE:

How fast you move the sprayer will affect spray application. If material is pulsating, you are moving too fast. If material drips, you are moving too slow. See **Troubleshooting**.

AIM THE SPRAYER

Aim the sprayer at the bottom edge of the previous stroke, overlapping each stroke by 50%. Pull the trigger after starting the stroke and release before the end of the stroke.

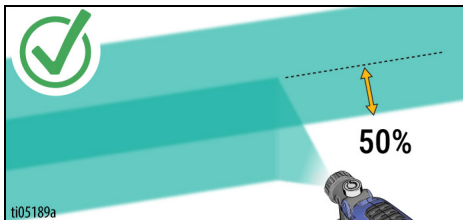

TRIGGER TIMING

Pull Trigger after starting stroke. Release Trigger before end of stroke. Sprayer must be moving when Trigger is pulled and released.

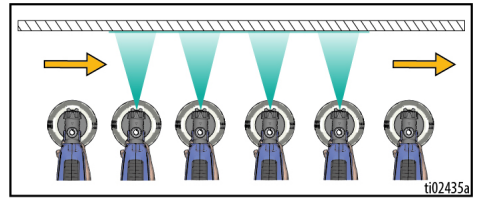

CLEAR THE NOZZLE

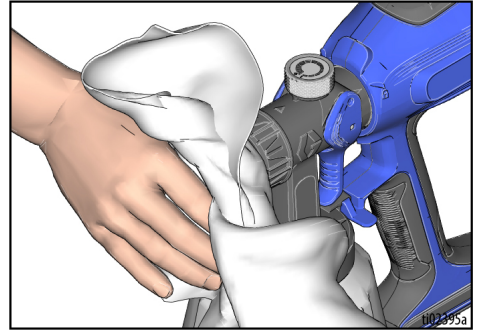

After spraying for long periods of time, dried paint will start to build-up on the Nozzle. To insure best performance, wipe the front of your sprayer with a wet rag to remove dried paint.

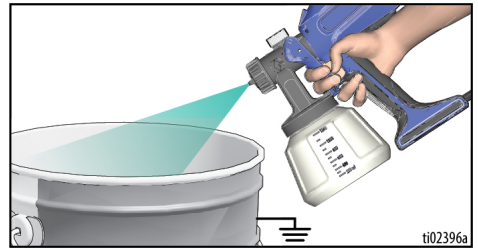

After removing build-up, spray into waste pail for a few seconds to ensure good flow and continue spraying.



CUP REFILLS

WARNING				
				
<p>Use only water-based or oil-based (mineral spirit-type) materials with a flash point greater than 100° F (38° C).</p> <p>Do not use materials which state "FLAMMABLE" on the packaging. For more information about your material, request a Safety Data Sheet (SDS) from distributor or retailer.</p> <p>When spraying oil-based material, use outdoors or in a well-ventilated indoor area with a flow of fresh-air.</p> <p>Keep spray area well-ventilated. Keep a good supply of fresh air moving through the area.</p>				

1. Unplug the sprayer to prevent accidental triggering while disconnecting the Spray Head and Turbine.
2. Disconnect the Spray Head from the Turbine and Handle.
3. To disconnect the Spray Head, push down on the back tab and rotate the Turbine counterclockwise. Pull the Turbine straight back from the Spray Head and set aside.

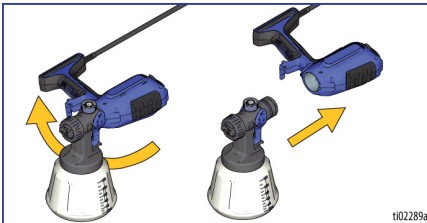

4. Refill the Cup following **Setup**.

PAUSE IN SPRAYING

Paint will dry quickly and cause clogs in the sprayer. Follow these steps whenever you pause spraying for five minutes to two hours.

1. Unplug Power Cord.

2. Wipe front of sprayer with a wet rag before resuming spraying.

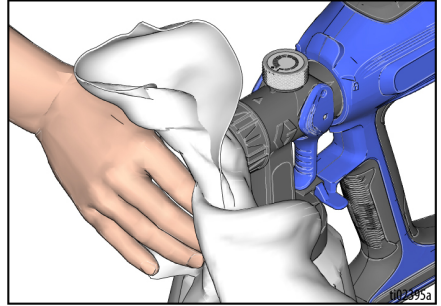

CLEANUP

The instructions provide guidance on how to clean the EVO HVLP Sprayer.

! WARNING			
			

Use only water-based or oil-based (mineral spirit-type) materials with a flash point greater than 100° F (38° C).

Do not use materials which state "FLAMMABLE" on the packaging. For more information about your materials, request a Safety Data Sheet (SDS) from the distributor or retailer.

Keep spray area well-ventilated. Keep a good supply of fresh air moving through the area.

To avoid serious injury or damage to equipment, do not expose the sprayer electronics to cleaning fluids. Keep sprayer **at least 10 in. (25 cm)** above the rim of the container when cleaning.

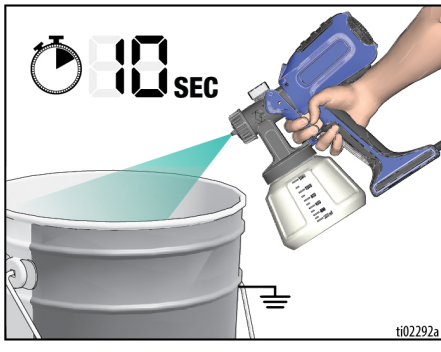

FLUID COMPATIBILITY

Oil or water-based materials

If spraying **water-based** materials, use water for cleanup. If spraying **oil-based** materials, use non-flammable mineral spirits for cleanup.

- Switching between **water-based** and **oil-based** materials can cause clogging issues in the sprayer. Always clean sprayer thoroughly with appropriate cleaning fluid.
- Flush the sprayer with non-flammable mineral spirits prior to using **oil-based** materials.

CLEAN THE SPRAYER

Cleaning your sprayer properly and after every spray job is of the utmost importance! Proper care and maintenance will help your paint sprayer last and work for you trouble-free.

1. Unplug Power Cord.
2. Remove the Turbine from the Spray Head.

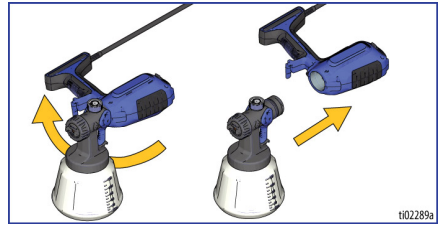

3. Unscrew the Cup from the Spray Head.

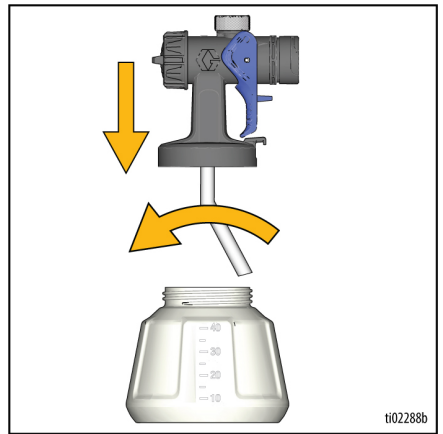

CLEANUP

4. Pour excess material back into the can. Clean the Cup with warm water.

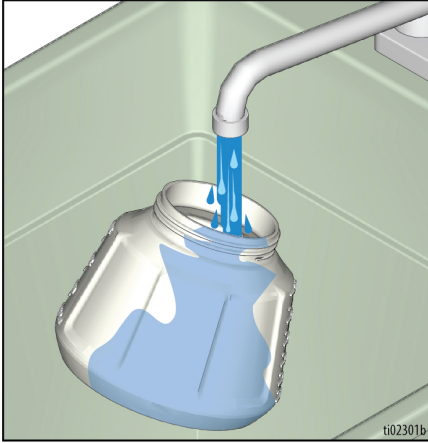

CLEAN THE SPRAY HEAD

1. Unscrew the Union Nut from the Spray Head. Remove the Air Cap and Nozzle and set aside.

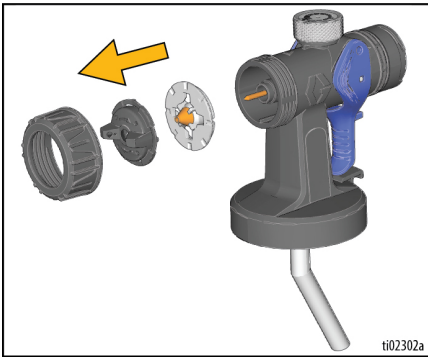

2. Attach the Power Flush™ adapter to the Spray Head. Screw the Union Nut back onto the Spray Head.

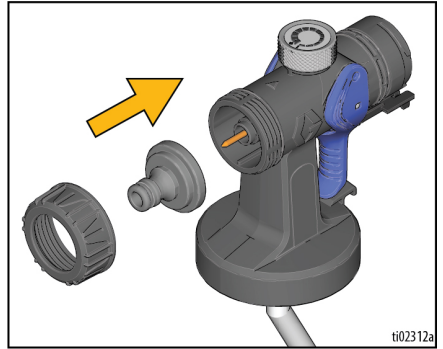

3. Attach the Power Flush adapter to a faucet or garden hose. Align the Spray Head with the provided Power Flush adapter and push it until it clicks into place.

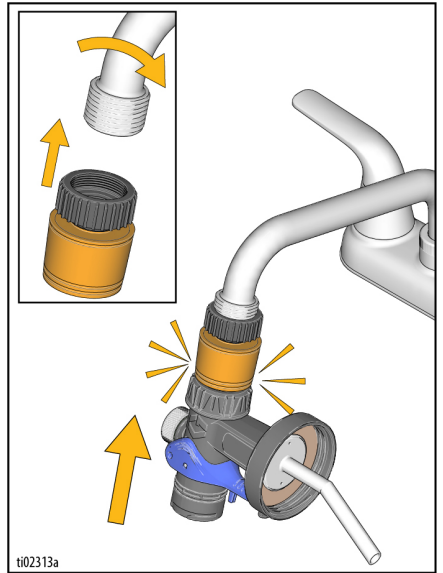

CLEANUP

- Once installed, turn on the water and run for 20 seconds or until the water runs clear.

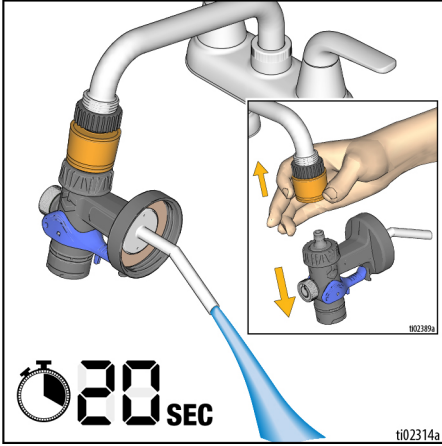

- Turn off the water and detach the Spray Head from the Power Flush adapter by pulling on the collar of the adapter.
- Using a wet rag, wipe down the Suction Tube.

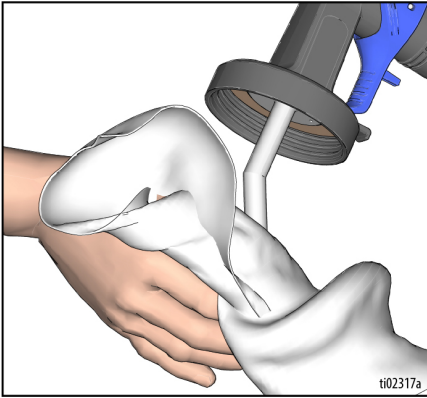

- Store sprayer with Spray Head removed from Cup to ensure all parts are dry.

CLEAN NOZZLE AND AIR CAP

- Using the included cleaning brush, scrub the Nozzles and Air Cap using warm water until they are free of material.

- If the Air Cap is covered with overspray, use the included cleaning brush to remove the unwated material.

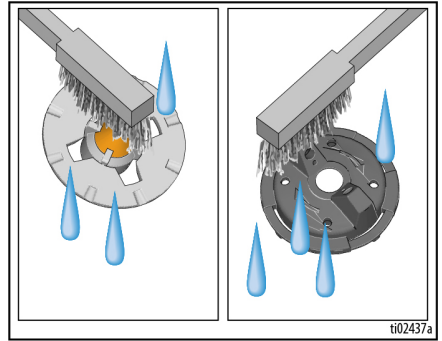

NOTICE

Failure to clean the Nozzle and Air Cap after each use may cause operational problems.

REPAIR

Regular cleaning, flushing, lubrication, and tightening of fasteners/connections will keep the equipment in good operation.

GASKET REPLACEMENT

If the gaskets become damaged the Cup will not be able to seal properly and the sprayer will not spray.

Each sprayer is provided with an additional outer and inner gasket for repair purposes.

REPLACE THE OUTER GASKET

1. Unplug Power Cord.
2. Starting with a clean Spray Head, see **Clean the Sprayer**. Remove the Suction Tube from the Spray Head.
3. Remove the damaged outer gasket (B) and dispose of properly.

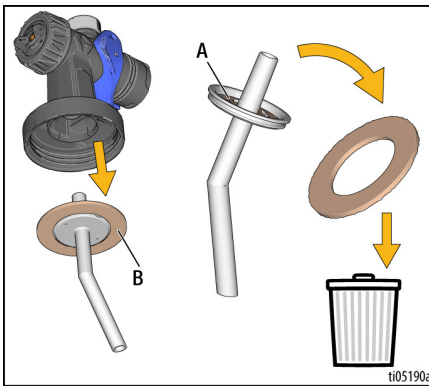

A Inner Gasket

B Outer Gasket

4. Place the new outer gasket over the top of the Suction Tube so that it is centered. Push the inner edge of the gasket into the channel. Roll the gasket so that it is fully seated in the channel.

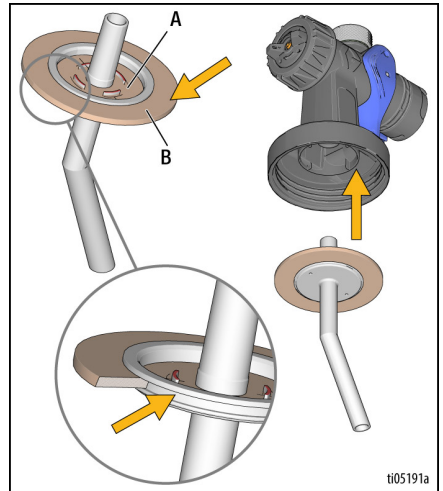

5. Insert the Suction Tube back into the Spray Head. Once the Suction Tube is back in place. Gently push the gasket back into place with a finger.

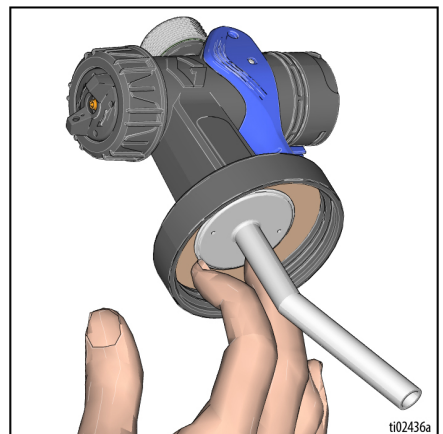

6. Follow **Setup** and begin spraying.

REPLACE THE INNER GASKET

1. Unplug Power Cord.
2. Starting with a clean Spray Head, see **Clean the Sprayer**. Remove the Suction Tube from the Spray Head.
3. Remove the damaged inner gasket (A) and dispose of properly.

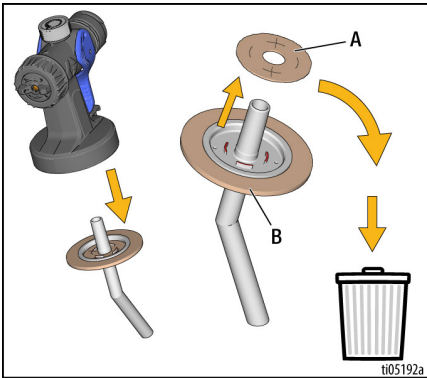

4. Slide the new inner gasket over the top of the Suction Tube and push down until it is seated in the pocket.

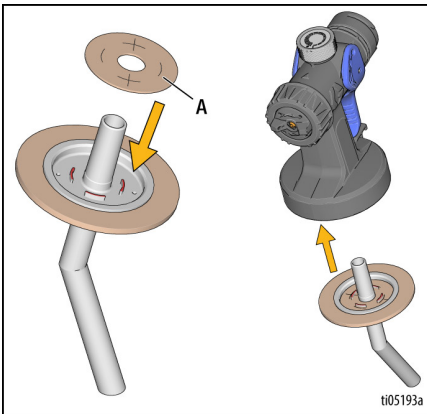

5. Insert the Suction Tube back into the Spray Head. Once the Suction Tube is back in place. Gently push the gasket back into place with a finger.

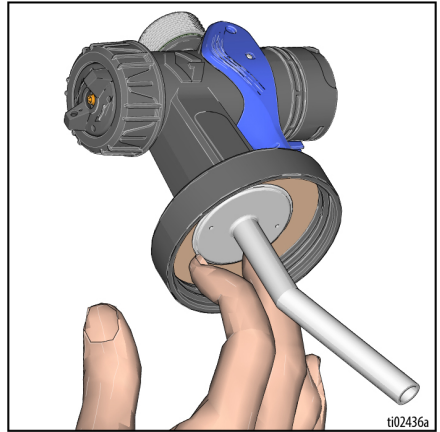

6. Follow **Setup** and begin spraying.

PARTS REPAIR AND REPLACEMENT

There are no serviceable parts in the sprayer. The user should not repair the sprayer.

This sprayer is a double-insulated product. Two systems of insulation are provided instead of grounding. No grounding means is provided on a double-insulated product, nor should a means for grounding be added to the sprayer.

A double-insulated product is marked with the words, "DOUBLED INSULATION" or "DOUBLE INSULATED." A double insulation symbol is also marked on the sprayer and appears as shown below:

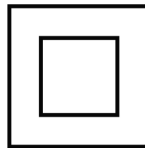

STORAGE

Proper care and storage will ensure the equipment remains in good operation.

LONG TERM STORAGE

NOTICE

Failure to store the sprayer properly will result in operational problems the next time you spray.

- Do not store the sprayer full of water.
 - Do not allow water to freeze in sprayer.
 - Store sprayer indoors in a cool, dry location.
 - Never store sprayer with material in the sprayer cup.
1. Clean the sprayer and cup assembly, see **Cleanup**.
 2. When storing the sprayer, leave the Spray Head detached from the Cup to allow parts to dry.

RECYCLING AND DISPOSAL

Properly recycle and dispose of the EVO HVLP Sprayer at the end of its useful life to minimize environmental impact and to ensure safe handling.

END OF PRODUCT LIFE

At the end of a product's useful life, recycle it in a responsible manner.



- Drain and dispose of fluids according to applicable regulations. Refer to the material manufacturer's Safety Data Sheet.
- Remove motors and other electronic components. Recycle according to applicable regulations.
- Do not dispose of electronic components with household or commercial waste.



- Deliver remaining product to a recycling facility.

TROUBLESHOOTING

When problems occur, use the table to identify potential causes and solutions to repair the EVO HVLP Sprayer.

 WARNING				
				

Check everything in this Troubleshooting Table before you bring the sprayer to an authorized service center.

SPRAYER DIAGNOSTICS

PROBLEM	CAUSE	SOLUTION
Sprayer makes sound but no material is sprayed when Trigger is pulled.	Nozzle is clogged	See, Clear the Nozzle.
	Suction Tube is clogged	Remove the Cup from the Spray Head and follow Cleanup.
	Cup is not tight	Make certain that the Cup is tight. If the Cup is not tight it cannot build pressure needed to spray.
	No or low material in the Cup	Refill Cup, see Cup Refills.
	Cup gaskets are damaged	See Cleanup.
	Material is too thick	Thin material with compatible material per manufacturer's specifications.
Material leaking	Material buildup on Air Cap and Nozzle	Clear the Nozzle
	Cup is not tight	Make certain that the Cup is tight. If the Cup is not tight, paint may leak into the threads.
	Nozzle loose	Make certain that the Union Nut is tight. If the Union Nut is not tight, paint will leak behind the Nozzle.
Spray pattern has dripping/sagging:  <small>1115522b</small>	Operator is moving too slowly while spraying	Move sprayer faster when spraying
	Sprayer is too close to target surface	Move sprayer away from surface. See Spraying.
	Holding Trigger while changing spray direction	Release Trigger when changing directions. See Spraying.
	Material flow is set too high	Reduce flow until the desired pattern is achieved or reduce the Nozzle size to achieve desired pattern. See Spraying.
Spray pattern is pulsating:	Material in Cup is running out	See, Cup Refills.

TROUBLESHOOTING

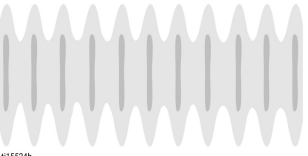
PROBLEM	CAUSE	SOLUTION
 <small>n15524b</small>	Material is too thick	Thin material with compatible material per manufacturer's specifications.
Spray pattern is very light and splotchy	Operator is moving too fast	Slow speed of movement.
	Nozzle is clogged	Increase the flow using the Flow Control Knob.
	Material flow setting too low	Increase the Nozzle size, see Spray Nozzle .
	Material is too thick	Thin material with compatible material per manufacturer's specifications.

CALIFORNIA PROPOSITION 65

CALIFORNIA RESIDENTS



WARNING Cancer and reproductive harm – www.P65warnings.ca.gov.

GRACO LIMITED WARRANTY

Graco warrants to the original purchaser that this product will be free from defects in material and workmanship for one (1) year from the date of purchase when operated and maintained in accordance with Graco's written recommendations and instructions. This product is designed and intended for personal, non-income producing, household purposes only. This warranty is void if the product is used for any other purposes, including but not limited to commercial, institutional, industrial, agricultural, rental or income producing purposes. This warranty does not cover general wear and tear or any malfunction, damage, or wear caused by misapplication, abrasion, corrosion, inadequate or improper maintenance, abuse, negligence, misuse, accident, tampering, substitution of non-Graco component parts, or alterations, service or repairs by anyone other than a Graco authorized service center, or any use, maintenance or repairs not specifically described in Graco's written recommendations and instructions. In addition, this warranty specifically excludes general wear and tear of the pump, valves, needle assembly and spray tips.

This warranty is conditioned upon the prepaid return of the product claimed to be defective and proof of purchase to a Graco authorized service center for verification of the claimed defect. To find a Graco authorized service center, please call 1-888-541-9788 or visit us online at www.graco.com. If the claimed defect is verified, Graco will repair or replace the product free of charge. The product will be returned to the original purchaser transportation prepaid. If inspection of the equipment does not disclose any defect in material or workmanship, repairs will be made at a reasonable charge, which charges may include the costs of parts, labor, and transportation. Repair or replacement of the product under this warranty will not interrupt or extend the warranty period or create a new warranty period.

ANY IMPLIED WARRANTY OF MERCHANTABILITY OR FITNESS FOR A PARTICULAR PURPOSES IS LIMITED TO ONE (1) YEAR FROM THE DATE OF PURCHASE. SOME STATES AND PROVINCES DO NOT ALLOW LIMITATIONS ON HOW LONG AN IMPLIED WARRANTY LASTS, SO THE ABOVE LIMITATION MAY NOT APPLY TO YOU.

To the extent permitted by law, Graco's sole obligation and buyer's sole remedy for any breach of warranty shall be as set forth above. **IN NO EVENT WILL GRACO BE LIABLE FOR ANY INDIRECT, INCIDENTAL, SPECIAL OR CONSEQUENTIAL DAMAGES RESULTING FROM THE SALE OR USE OF THIS PRODUCT. SOME STATES AND PROVINCES DO NOT ALLOW THE EXCLUSION OR LIMITATION OF INCIDENTAL OR CONSEQUENTIAL DAMAGES, SO THE ABOVE LIMITATION OR EXCLUSION MAY NOT APPLY TO YOU.**

THIS WARRANTY GIVES YOU SPECIFIC LEGAL RIGHTS, AND YOU MAY ALSO HAVE OTHER RIGHTS WHICH VARY FROM STATE TO STATE OR PROVINCE TO PROVINCE.

FOR GRACO CANADA CUSTOMERS The Parties acknowledge that they have required that the present document, as well as all documents, notices and legal proceedings entered into, given or instituted pursuant hereto or relating directly or indirectly hereto, be drawn up in English. Les parties reconnaissent avoir convenu que la rédaction du présente document sera en Anglais, ainsi que tous documents, avis et procédures judiciaires exécutés, donnés ou intentés, à la suite de ou en rapport, directement ou indirectement, avec les procédures concernées.

GRACO INC. AND SUBSIDIARIES | P.O. BOX 1441 | MINNEAPOLIS MN 55440-1441 | USA

Graco Headquarters: Minneapolis, MN USA | International Offices: Australia, Belgium, China, Japan, Korea | Toll Free Phone Number: 1-800-690-2894 (Contractor Division) and 1-800-328-0211 (Industrial Division) | For patent information, see graco.com/patents

©2026 Graco Inc. All written and visual data in this document are based on the latest product information available at the time of publication. Graco reserves the right to make changes at any time without notice. All Graco manufacturing locations maintain ISO 9001:2015 certifications, each certified by accredited certification bodies. Original Instructions. This manual contains English. Revision B, January 2026